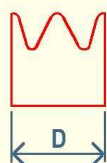
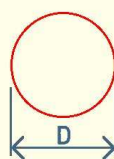

cowie® PTFE Stirring Magnets

[HOME](#)
[LABWARE INDEX](#)
**Tube**

Designed for use with 10mm standard cuvettes

**Sphere**

Of special interest for tubes and for eccentric stirring

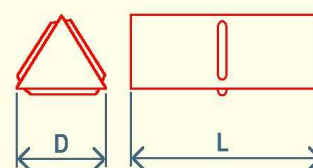
**Triangle with Rib**

Excellent turbulence at low speeds and can be used on slightly curved or uneven surfaces

Reference	L (mm) x D (mm)	Reference	D (mm)	Reference	L (mm) x D (mm)
001.1609	6 x 9	001.1512	12	001.1812	12 x 6
				001.1825	25 x 8
				001.1835	35 x 9
				001.1850	50 x 12
				001.1880	80 x 18

NB: The dimensions of stirrer bars are nominal and approximate to the stated value by $\pm 5\%$ for length and $\pm 10\%$ for diameter

[cowie®](#)